



**Your in wall plumbing is too deep  
and you can't screw on your flanges?**



### **EZYFIX Trouble-shooter:**

This guide provides a solution that can be used on all wall mounted Modern Lever taps.

# Here's a solution...

The simplest solution is to purchase extra black PVC threaded extenders as pictured here:



1. These black PVC extenders are M&F so can be screwed into each other end to end to achieve extra height when screwed into the wall dress flange.
2. This should now allow you to screw on your wall dress flanges.
3. If not then there is another solution.



1.



2.

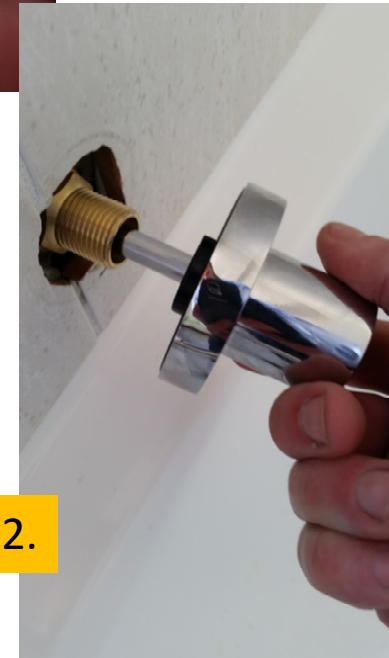

# Here's another solution...

Purchase an [EZYFIX in wall ceramic disc seat extender kit](#).

1. Screw the in-wall extension adaptor by hand at first ensuring the fibre body washer is in-place. Tighten with the 29mm sized end of our [EZYFIX tough tube spanner kit](#).
2. Screw in the cartridge only, don't overtighten.
3. Screw on locknut with fibre body washer and re-dress tapware as per our Tapware instructions.
4. Job done!

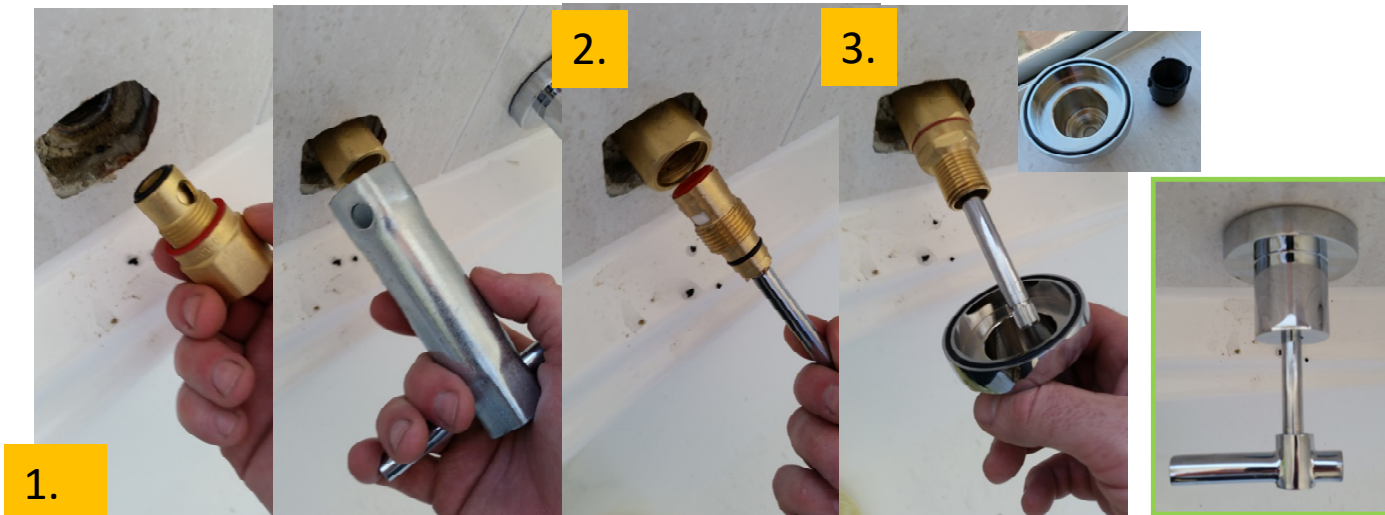

**Still having issues?  
Don't return the set,  
simply call or email  
us. We are here to  
help. 😊  
Ph 1300 399 349**